

Model Shown:
9040E



Accessories



Accessories for Analog Gauges



9046 - Silicone Fill Kit

Silicone fill kit. 212 gr. Requires one bottle to fill 102 mm gauge; four bottles to fill 152 mm gauge.



9049 - Dampener Fitting

High-performance pulsation dampener. 1/4" NPTF male x 1/4" NPTF female.

Features

HEAVY-DUTY HYDRAULIC PRESSURE GAUGES

- Gauges feature an easily readable and highly visible, red Day-glo® needle.
- High strength steel bourdon tube ensures high cycle life.
- Stainless steel cases and lens locking rings.
- Have 1/4" NPT connections.
- Gauges are calibrated and comply to ASME B40.1 GRADE B



Typical Set-Up - Mounting Situations

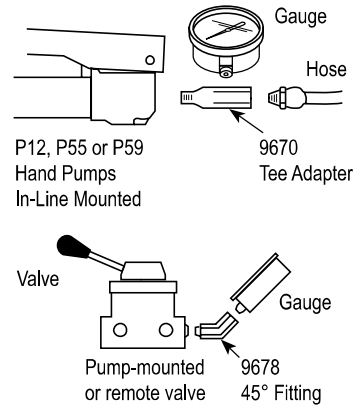

Ordering Information

Order Number	Face Dia. (mm)	Pressure Range (bar)	Tonnage Range (ton)	Major Graduations (bar)	Minor Graduations (bar)	Silicone Filled (Yes/No)	Use With Cylinder Series
9040E	63,5	0 - 690	-	2000 psi, 100 bar	200 psi, 20 bar	Yes	All
9052E	101,6	0 - 690	-	1000 psi, 100 bar	100 psi, 20 bar	Yes	All
9053E	101,6	0 - 690	0-5	2000 psi, 1 Ton	200 psi, 0,1 Ton	No	C & RLS
9055E	101,6	0 - 690	0-10	2000 psi, 1 Ton	200 psi, 0,1 Ton	No*	C, RD, RH, RLS & RSS
9057E	101,6	0 - 690	0-15	2000 psi, 1 Ton	200 psi, 0,2 Ton	Yes	C
9059E	101,6	0 - 690	0-17,5, 0-30, 0-50	2000 psi, 5 Ton	200 psi, 0,5 Ton on 30, 50 Ton Scales; 0,2 Ton on 17,5 Ton Scale	No*	RT172, RT302, RT503
9061E	101,6	0 - 690	0-20	2000 psi 5 Ton	200 psi, 0,5 Ton	Yes	RH, RLS, RSS
9063E	101,6	0 - 690	0-25	2000 psi 5 Ton	200 psi, 0,5 Ton	No*	C & RD
9065E	101,6	0 - 690	0-30	2000 psi, 5 Ton	200 psi, 0,5 Ton	No*	RH†, RLS & RSS
9067E	101,6	0 - 690	0-50	2000 psi, 5 Ton	200 psi, 0,5 Ton	No*	RH†, RLS & RSS
9069E	101,6	0 - 690	0-55	2000 psi, 5 Ton	200 psi, 0,5 Ton	No*	C, R, RA & RD
9071E	101,6	0 - 690	0-60	2000 psi, 5 Ton	200 psi, 1 Ton	No*	RH, except RH6010
9073E	101,6	0 - 690	0-75	2000 psi, 5 Ton	200 psi, 1 Ton	Yes	C, RLS & RD8013
9075E	101,6	0 - 690	0-100	2000 psi, 10 Ton	200 psi, 1 Ton	No*	C, R, RA, RD, RH, RLS†, RSS† & RT1004†
9077E	101,6	0 - 690	0-150	2000 psi, Initial 10 Then 20 Ton	200 psi, 2 Ton	No*	C, R, RD & RLS
9079E	101,6	0 - 690	0-200	2000 psi, 20 Ton 10 Then 20 Ton	200 psi, 2 Ton	No*	R, RD & RH†
9089	152,4	0 - 690	0-690	1000 psi, 100 bar	100 psi, 10 bar	No	All

* Shipped "dry." User can convert to "wet" using liquid silicone No. 9046.

† The tonnage scale on the gauge may vary slightly among different series cylinders due to different effective area.

Model Shown:
DG100



Features

DG100 DIGITAL PRESSURE GAUGES

- Accurate to within 1%, Long-life pressure transducer.
- Pressure values are displayed on large red LEDs in 0,7 bar or bar increments.
- "Peak" hold feature with reset toggle switch and "Peak On" indicator; Hi/Low set point feature with relay outputs for Hi/Low alarms and/or control signals.
- A slow flashing display indicates pressure below the low limit. Fast blinking display alerts if limit is exceeded.
- High and low limit relays are rated to 5 amps at 115V.
- Operating temperature of -18 to 60°C for the electronic display and -29 to 82°C for the transducer.
- Gauge housings are extruded aluminum 1/8" DIN enclosures (NEMA 1 rating).
- When power cable is connected to gauge, display will scroll all characters, performing a self- diagnostic routine.
- 1/4" NPTF male threads for the pressure connection.
- 6-foot input signal cable connects to back of display unit.

Accessories



Typical Set-Up - Mounting Situations



- **DG100** (bar) digital gauge.
- **DG100B** (bar) digital gauge.

Upgrade to **DG100** or **DG100B** when:

- Hi/Low alarms required.
- Relays triggered by Hi/Low pressure.
- Pressure display needs to be remotely mounted from measurement location.
- Accurate within 1% @ Full Scale.



Accessories for DG100



420778 - Digital Gauge Stand

Gauge stand for DG100. Has angled base mounting to hold gauge at a convenient viewing angle. Wt., 0,5 kg.



37045 - Auxiliary Power Cord

Auxiliary power cord for use with any 12 or 24V battery. Wt., 0,1 kg. *Caution: For use on negative ground systems only.*

Ordering Information

Order Number	Description	Pressure Range (bar)	Prod. Wt. (kg)
DG100 *	Digital pressure gauge	0 - 700	1
DG100B *	Digital pressure gauge	0 - 700	1

* Serviced only at factory.

Model Shown:
9042DG, 9042DG1500



Accessories

Features

- Digital gauge is easier to read and offers better accuracy than a conventional analog gauge.
- The laser welded stainless steel sensor & socket and the IP67 weatherproof rating make this product suitable for use in the most demanding of applications.
- Five pre-programmed engineering units allow technicians to read pressure in the unit of measure most applicable to the process.
- The gauge also features a bar graph display feature for enhanced visibility.
- Includes automatic-off battery conservation, pressure tare, minimum pressure memory and maximum pressure.
- Vibration & shock tested to MIL-STD-202G.
- Agency Compliance / Approval: RoHS, CE, ASME B40.7, UL, cUL 61010-1.
- The gauges are calibrated for life at the factory and can be certified in the field, if required.

▶ *Power Team's 9042DG was the perfect choice in accurately monitoring the force applied in this H frame press application.*



▶ Technical Attributes



- 1 Protective rubber boot
- 2 Back-light and large 12,2 mm display easy reading
- 3 Displays in multiple engineering units: psi, bar, mPa, inHg, kg/cm²
- 4 Weatherproof IP67 enclosure
- 5 2,000 hr. life, (2) AA (LR6) batteries
- 6 Typical Cycle Life: 10,000,000
- 7 1/4" NPTF Male Threads (9042DG); 9/16-18 UNF-2B (9042DG1500). High pressure 60° core port.

▶ Technical Specifications

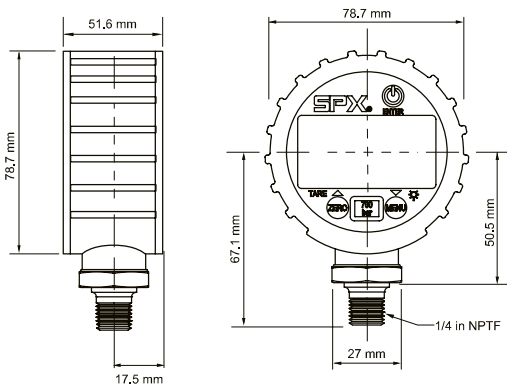

▶ Ordering Information

Order No.	Face Dia. (mm)	Rated Pressure (bar.)	Temp Range (°C)	Tool Use	IP Rating	Batteries Included	Battery Life (hrs.)	F.S. Accuracy	Prod. Weight (kg)
9042DG	63,5	0-700	-20 to +60	All	IP67	2 x AA (LR6)	2000	0.50%	0,24
9042DG1500	63,5	0-1500	-20 to +60	All	IP67	2 x AA (LR6)	2000	0.25%	0,24



Typical Mounting Setups for 9042DG

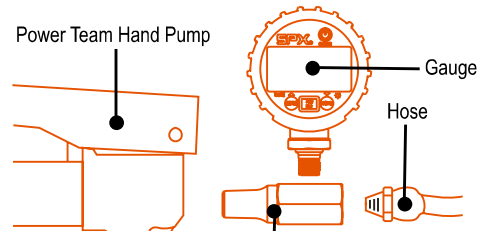

Tee adapter (No. 9670) is used for installing a gauge in line in a hydraulic circuit.

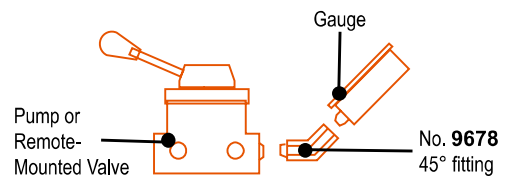

Hardware Requirements for 9042DG



- Does your pump have a 3/8" or 1/4" NPTF port?
- Are you direct-plumbing the gauge to your tool or seeking to quick-disconnect?
- Refer to the Power Team Catalog under the accessories section for a comprehensive range of fittings and couplers to meet your needs.



Custom Scale

User programmable unit of measure allows you to set a custom scale to have the gauge display torque, force or weight to match the cylinder or tool being used.



Safety Tip

When using couplers to detach the gauge, always use a metal cover (ordered separately) on the pump side (female) coupler when the gauge is removed.