

Model Shown:

PR3100J, PR3100S



Features

UNIVERSAL RAILROAD AXLE JOURNAL ROLLER BEARING PULLER/INSTALLER.

- Quickly remove or install tapered roller bearings.
- With both sling and jack models available and two pumps to choose from, you can tailor the unit to match your needs.
- The industry standard in most wheel shops.
- Each unit will service a full line of bearings with rotating end caps, from class B thru GG.
- Designed with the cooperation of major bearing manufacturers.
- Fast, simple, one-person operation with 100-tons of pulling force provided.
- Completely portable for easy, convenient positioning and out-of-the-way storage.
- Each unit complete with a heavy-duty 100-ton hydraulic cylinder, 700 bar pump with remote control solenoid valve, hydraulic pressure gauge (11543), a pulling shoe and installing tube.
- CSA certified (LR19814)



Our roller bearing pullers are ideal for replacing tough, worn-out bearings on RR freight cars.



The photo above shows the Universal Puller in position on the roller bearing assembly, which is ready for removal.



Protective Blankets



Power Team has protective blankets available which may afford protection from injury to users and others should part breakage occur. For more information, see page 242.



CAUTION

Power Team recommends the use of these blankets for all pushing, pulling, pressing, and lifting applications.

Ordering Information

Order No.	Model Type	Cylinder Type	Valve Type	Kw	Pump Information Phase	Voltage
PR2100J-E220 †	Jack	Double-Acting	Solenoid	1,5 **	1	230 V*
PR3100J-E380 †	Jack	Double-Acting	Solenoid	2,2	3	400 V*
PR2100S-E220 †	Sling	Double-Acting	Solenoid	1,5	1	230 V*
PR3100S-E380 †	Sling	Double-Acting	Solenoid	2,2	3	400 V*

* Prewired at factory for these voltages. Other voltages available upon request.

** The 2 hp, 115VAC requires 30 amp service.

† Equipped with hydraulic pressure gauge 11543.

► Tooling Ordering Information

IMPORTANT: This tooling chart applies only to standard AAR configurations for freight car applications. In order to provide adapters needed to service housing-type locomotive and passenger car bearings, as well as metric bearings, Power Team must be provided with the following information. Bearing manufacturer's name and general arrangement drawing number, size of bearing to be serviced, railroad name and location and part numbers of adapters already in your possession if you currently own a Puller/Installer.

Tool Description	Class and size of bearing assembly - TBU & SP "Metric Tooling"			
	120	130	140	150
Pulling Shoe, Insert Adapter	351830	30512	30521	30520
Guide Tube & Cap Screw Assy.	253341	253342	253343	253344
Cap Screw *	253339	253394	253339	253395
Guide Tube Adapter	212247	21247	21247	21247
Installing Tube Adapter Ring	253335	253336	253337	253338

* Screws are supplied with the guide tube and should be ordered as replacements only.

Tool Description	Class and size of bearing assembly to be serviced									
	Class B 108 x 203	Class C 127 x 229	Class D 140 x 254	Class E 152 x 279	Class EE 140 Axle	Class EE 152 Axle	Class F 165 x 305	Class G 178 x 305	Class G 165 Axle	Class GG 165 Axle
Pulling Shoe	420845 is included as part of basic machine - Do Not Order							420846	420846	420846
Pulling Shoe, Insert Adapter	30522	30512	30521	30520	30520	30519	30519	—	—	—
Guide Tube & Cap Screw Assy.	253313	253314	253317	253318	253316	253327	253320	253321	253319	253323
Cap Screw *	253156	253349	253308	253155	253307	253308	253310	253326	253309	253309
Guide Tube, No Adapter	23934	21248	21248	21247	21247	21247	21247	21247	21247	21247
Installing Tube	30416 is included as part of basic machine - Do Not Order							30417	30417	30417
Installing Tube Adapter Ring	21242	21258	21256-1	21255-1	21255-1	21257-1	21257-1	30586	30585	30585

* Screws are supplied with the guide tube and should be ordered as replacements only.

NOTE: Adapters listed above are for servicing the following roller bearing assemblies: Brenco "Crown-Taper", New Departure-Hyatt "Hy-Roll Taper", SKF "Expediter" and Timken "AP".

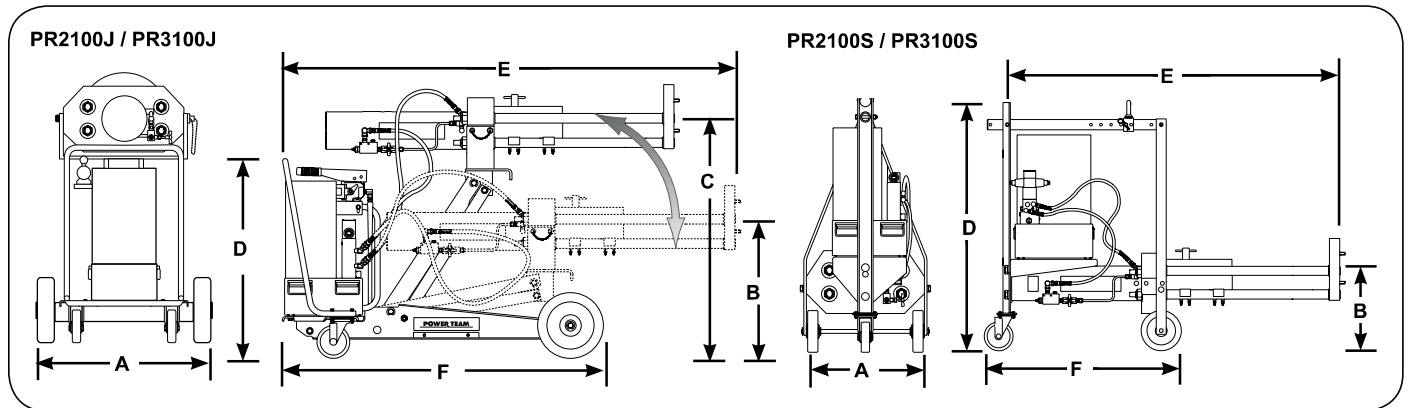

► Technical Dimensions

Order No.	A	B	C	D	E	F	Stroke (mm)	Capacity		Advance (mm/min.)	Speed		Weight (kg)
	(mm)	(mm)	(mm)	(mm)	(mm)	(mm)		Pull (tons)	Inst. (tons)		Pull (mm/min.)	Inst. (mm/min.)	
PR2100J	813	383	1059	912	1981	1493	394	100	68	900	81	113	528
PR3100J	813	383	1059	912	1981	1493	394	100	68	900	81	113	520
PR2100S	619	279	—	1283	1632	985	394	100	68	900	81	113	455
PR3100S	619	279	—	1283	1632	985	394	100	68	900	81	113	458

UNIVERSAL BEARING CUP INSTALLER



This installer adjusts to fit bearing cups from 92 to 165 mm O.D. It replaces over two dozen plates and drivers. Simply adjust the jaws to fit the cup I.D., lock the jaws, slip the new cup on and drive it home with a hammer.

Order No.	Description
7180	Universal bearing cup installer. Wt., 4,5 kg.

ASSEMBLE YOUR OWN "CUSTOM-MADE" DRIVER TOOLS



These sets include discs and handles for custom seal driver assembly to provide a pilot (to prevent cocking), a spacer (so force is applied on the proper area) and a driver (for even force dist.). Discs range from 12,7 thru 114,3 mm diameters in 1,6 mm increments. Each set includes a handy plastic box with pre-cut tool tray.

Order No.	Description
27793	STARTER SET. Contains handle and discs especially selected to provide the driver sizes most frequently needed. Maximum utility at a modest investment! Wt., 1,8 kg.



27797 Master Set
(Board not included)

Patent No. 4,429,447

Order No.	Description
27794	BASIC SET. Wide coverage, low investment! Includes 41 discs and two handles. Size range: 12,7 thru 76,2 mm diameter. Wt., 10 kg.
27795	BIG JOB SET. Used for servicing large components. You get coverage of 77,8 thru 114,3 mm diameter with the 24 discs and handle provided. Wt., 20,4 kg.
27797	MASTER SET. For maximum coverage. Three handle sizes and all 65 discs listed in chart below are included. Range: 12,7 thru 114,3 mm diameter. Wt., 30,9 kg.
212377	TOOL ORGANIZER BOARD. Will accommodate all components of 27797 Master Set. Tools not included. Wt., 2,3 kg.

DISCS

SET COMPONENTS

Order No.	Discs (mm)	Order No.	Discs (mm)	Order No.	Discs (mm)
27491	12,7	27512	46,0	27534	81,0
27492	14,2	27513 †	47,8	27535	82,6
27493 †	16,0	27514	49,3	27536	84,1
27494	17,5	27515	50,8	27537	85,9
27495 †	19,1	27516	52,3	27538	87,4
27496	20,6	27517	54,1	27539	88,9
27497 †	22,4	27518	55,6	27540	90,4
27498	23,9	27519	57,2	27541	92,2
27499 †	25,4	27520	58,7	27542	93,7
27500	26,9	27521	60,5	27543	95,3
27501 †	28,7	27522	62,0	27544	96,8
27502	30,2	27523	63,5	27545	98,6
27503 †	31,8	27524	65,0	27546	100,1
27504	33,3	27525	66,8	27547	101,6
27505 †	35,1	27526	68,3	27548	103,1
27506	36,6	27527	69,9	27549	104,9
27507 †	38,1	27528	71,4	27550	106,4
27508	39,6	27529	73,2	27551	108,0
27509 †	41,4	27530	74,7	27552	109,5
27510	42,9	27531	76,2	27553	111,3
27511 †	44,5	27532	77,7	27554	112,8
		27533	79,5	27555	114,3

Order No.	Description
10012 †	1/4"-20 UNC X 22,2 mm *
10020 †	1/4"-20 UNC X 31,8 mm *
10854 †	1/4"-20 UNC X 44,5 mm
10855 †	1/4"-20 UNC X 70 mm *
12001 †	1/4"-20 UNC X 57,1 mm *
27487 †	Small Handle 127 x 19 mm Dia.
27488	Med. Handle 152 x 41 mm Dia.
27489	Large Handle 152 x 41 mm Dia.
27490	Extension Tube
7350 †	Allen Wrench

* Socket head cap screw.

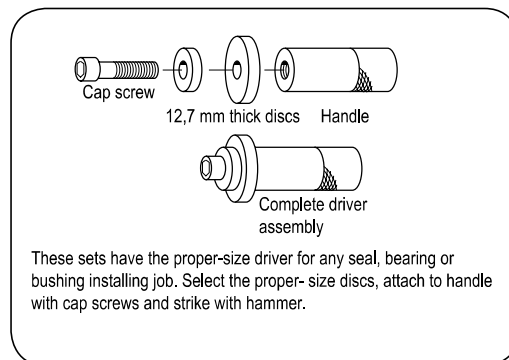

† Items contained in 27793 starter set.