

Model Shown:
TWHC3



Features

QUALITY MEANS LOWER COST OF OWNERSHIP

- Designed for high cycle life (2-3x more than existing technology)
- Increased reliability provided by simple drive assembly means less downtime
- Corrosion resistant material for use in harsh environments

ENHANCED USABILITY:

- Compact nose radius allows the tool to fit in tighter, hard-to-reach spaces
- Low weight, high strength design
- Fast operation, long stroke and optimum flow
- Multi-direction high flow swivel manifold
- Push-button square drive reversal and reaction arm positioning for all models except TWHC50

DESIGNED WITH SAFETY IN MIND:

- Fully-enclosed drive mechanism for operator safety
- Swivel manifold internal relief valve prevents retract side over-pressurization
- Fine tooth pawl prevents tool 'lock-on'

▶ The TWS50 is the perfect choice in this power generation application.



HANDLES SOLD SEPARATELY



The tool's designed long-stroke mechanism imparts a minimum 30 degree nut rotation per stroke while maintaining a tight and compact nose radius. This is a clear advantage over the short stroke and back-up pawl mechanisms of light alloy competitive models. Fewer parts and reduced torsion in operation equals reduced wear, maintenance and associated costs.

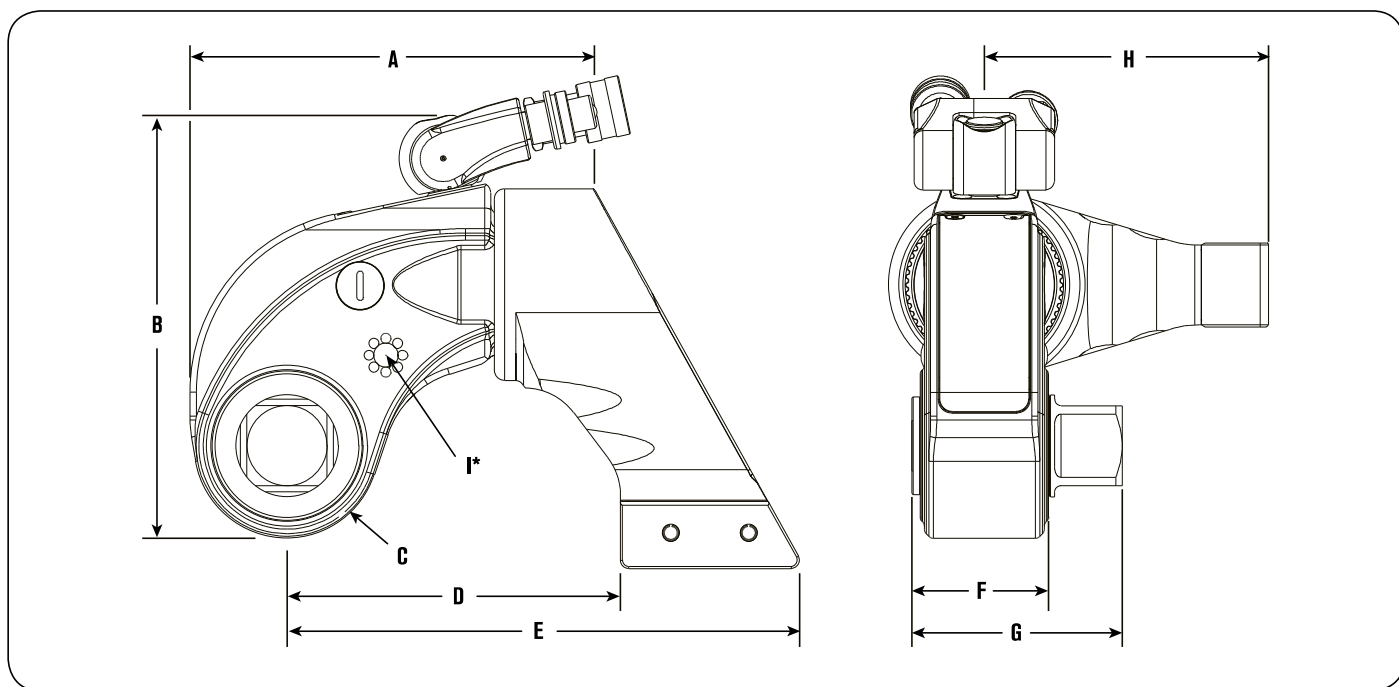

* Dimension I shows thread size (on both sides of the tool) for safety handle or lifting point. TWHC50 model available with lifting points only.

Technical Dimensions

Tool Model	Min Torque	Max Torque	Square Drive	A	B	C	D	E	F	G	H	I	Prod. Wt.
	(Nm)	(Nm)		(in.)	(mm)	(mm)	(mm)	(mm)	(mm)	(mm)	(mm)		
TWHC1	230	1916	3/4	132,1	145,0	27,9	111,5	169,9	39,6	67,8	86,1	M6 x 1.0	2,8
TWHC3	510	4252	1	165,1	173,5	36,6	129,5	197,6	53,1	83,8	105,1	M6 x 1.0	5,3
TWHC6	984	8203	1 1/2	192,0	201,7	43,9	158,5	243,6	61,0	99,8	135,1	M8 x 1.25	8,8
TWHC50	8623	71859	2 1/2	404,6	356,6	87,9	266,4	446,5	115,1	192,3	258,0	M12 x 1.75	68,9

Ordering Information

Order No.	Description
TWHC1	Wrench
TWHC3	Wrench
TWHC6	Wrench
TWHC50	Wrench

Order No.	Description
TWHC1H	Wrench with Handle
TWHC3H	Wrench with Handle
TWHC6H	Wrench with Handle

Order No.	Description
DFTAS000001	Handle for TWHC1
DFTAS000001	Handle for TWHC3
DFTAS000002	Handle for TWHC6

TWHC EXTENDED REACTION ARM TWHC-ERA



>Features

- Long reach version of TWHC standard reaction arm
- 3 standard sizes per model (25 mm / 50 mm / 75 mm), specials upon request
- Replaces standard reaction arm via quick release locking pin
- Steel alloy construction
- 360° rotation
- Available for full range of tool sizes

▶ Ordering Information

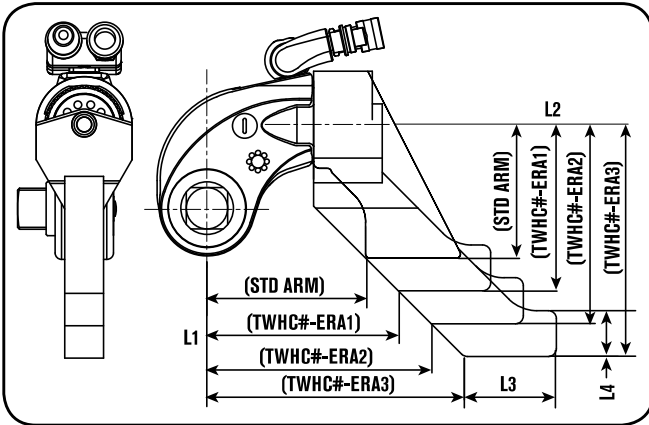

Tool Ref	Order No.	L1 (mm)	L2 (mm)	L3 (mm)	L4 (mm)	Weight (kg)
STD ARM		112,0	86,1	—	—	—
TWHC1	TWHC1-ERA1	136,9	111,0	59,9	30,0	2
	TWHC1-ERA2	162,1	135,9			2,3
	TWHC1-ERA3	186,9	161,0			2,6
STD ARM		130,0	104,9	—	—	—
TWHC3	TWHC3-ERA1	154,9	130,0	70,1	35,1	3
	TWHC3-ERA2	180,1	154,9			3,5
	TWHC3-ERA3	205,0	180,1			3,9
STD ARM		158,2	135,9	—	—	—
TWHC6	TWHC6-ERA1	183,9	161,0	95,0	39,9	5
	TWHC6-ERA2	209,0	185,9			5,6
	TWHC6-ERA3	233,9	211,1			6,2

TW HANDLE



>Features

- Robust steel construction with ribbed polymer grip
- Multi-position on tool for balanced handling
- Cap-screw locking with positive 'docking'
- Is suitable for all wrench models (TWHC, TWSD, TWLC). However, for larger sizes (TWSD25/TWLC 30/TWHC50) we recommend the use of eye-bolt lifting.

▶ Ordering Information

Order No.	Description	Tool Ref
DFTAS000001	Wrench Handle	TWSD1
		TWSD3
		TWHC1
		TWHC3
		TWLC2

Order No.	Description	Tool Ref
DFTAS000002	Wrench Handle	TWSD6
		TWSD11
		TWHC6
		TWLC4
		TWLC8
TWLC15		

TWHC REACTION PAD TWHC-RP



Features

- In-Line Reaction Pad for TWHC wrenches used as simple pad, or modified platform for specific application (Machine-able/Weld-able platform)
- Replaces standard reaction arm via quick release locking pin
- Steel alloy construction
- 360° rotation
- Available for full range of tool sizes

Ordering Information

Tool Ref	Order No.	L1	L2	L3	Width (mm)	Weight (kg)
		(mm)	(mm)	(mm)		
TWHC1	TWHC1-RP	72,0	116,0	49,0	64,0	1
TWHC3	TWHC3-RP	86,1	137,9	55,1	75,9	1,5
TWHC6	TWHC6-RP	99,1	162,1	62,0	88,9	2,3

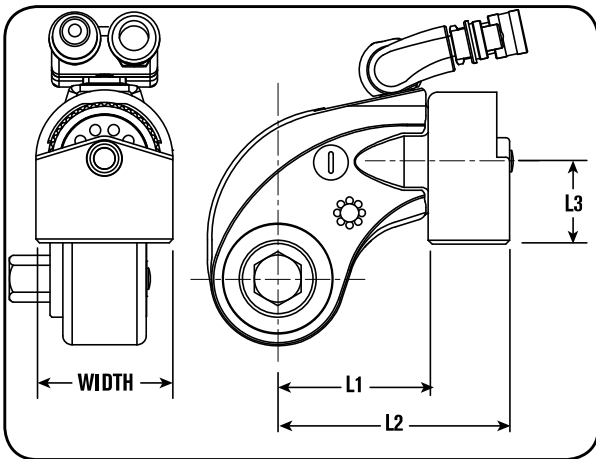

TWHC LONG REACTION ARM TWHC-LRA



Features

- Tubular extension arm for TWHC wrenches for in-line reaction outside wrench profile
- Replaces standard reaction arm via quick release pin locking
- Steel/light alloy construction (reaction flat machined on tube end)
- Can be cut down to suit specific length
- Available for full range of tool sizes

Ordering Information

Tool Ref	Order No.	L1	L2	Weight (kg)
		(mm)	(mm)	
TWHC1	TWHC1-LRA	500,9	152,4	4,5
TWHC3	TWHC3-LRA			6
TWHC6	TWHC6-LRA			8,1

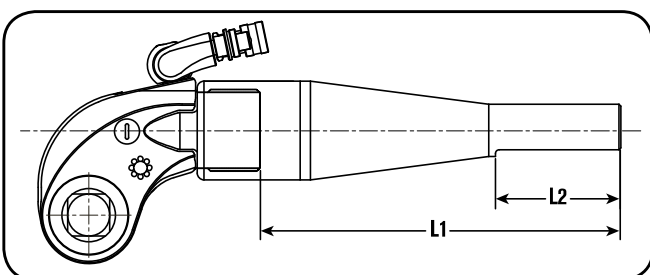

Model Shown:
TWSD11



Features

HYDRAULIC SQUARE DRIVE TORQUE WRENCHES

- Corrosion resistant finish, low weight, high strength steel body construction design with superior torsional strength.
- Fast operation cycle, fine tooth ratchet, with floating piston design.
- Multi-axis high flow swivel manifold with internal relief valve prevents retract side over-pressurization
- Push button reversal of square drive
- 360° reaction arm, with push to lock reaction arm.
- Simple design, fully enclosed drive mechanism, provides accurate torque output

NOTE: Standard Reaction Arm included for all models

▶ The TWSD11 is th perfect choice with a large reaction surface to eliminate damage to the gears during the tightening process.

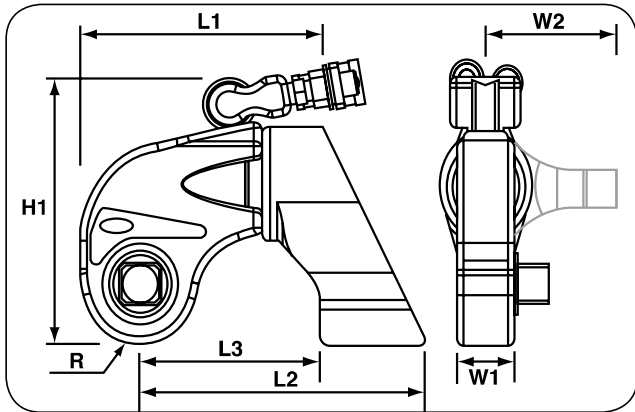

Technical Dimensions

Tool Model	L1 (mm)	L2 (mm)	L3 (mm)	H1 (mm)	R (mm)	W1 (mm)	W2 (mm)	Square Drive (in.)	Max. Torque (Nm)	Tool Wt. (kg)
TWSD11	233,9	292,1	178,1	241,0	55,9	61,0	165,1	1 1/2	14833	13,1
TWSD25	305,1	375,9	230,9	315,0	71,1	75,9	199,9	2 1/2	33489	29,5

Ordering Information

Order No.	Description	Order No.	Description
TWSD11	Wrench - 14833 Nm	DFTAS000002	Wrench Handle Size 2 Tool Ref. TWSD06 and TWSD11
TWSD25	Wrench - 33489 Nm		

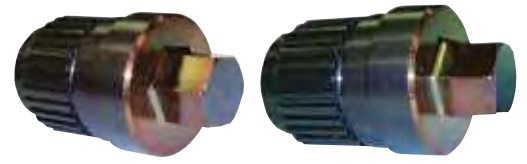

► **Ordering Information**

SQUARE DRIVE - ADAPTERS & SOCKETS							
Torque Wrench	Hexagon Drive Size AF (mm)	Order No.		Torque Wrench	Hexagon Drive Size AF (mm)	Order No.	
		TWSD	TWHC			TWSD	TWHC
(TWSD1) (TWHC1)	17		TWHCHD01-017	(TWSD6) (TWHC6)	30		TWHCHD06-030
	19		TWHCHD01-019		32		TWHCHD06-032
	22		TWHCHD01-022		36		TWHCHD06-036
	24		TWHCHD01-024		41		TWHCHD06-041
(TWSD3) (TWHC3)	17		TWHCHD03-017	(TWSD11)	27	TWD11-027	-
	19		TWHCHD03-019		30	TWD11-030	-
	22		TWHCHD03-022		32	TWD11-032	-
	24		TWHCHD03-024		36	TWD11-036	-
	27		TWHCHD03-027		41	TWD11-041	-
	30		TWHCHD03-030		46	TWD11-046	-
	32		TWHCHD03-032	(TWSD25)	36	TWD25-036	-
	36		TWHCHD03-036		41	TWD25-041	-
41		TWHCHD03-041	46		TWD25-046	-	
(TWSD6) (TWHC6)	17		TWHCHD06-017		50	TWD25-050	-
	19		TWHCHD06-019		55	TWD25-055	-
	22		TWHCHD06-022	60	TWD25-060	-	
	24		TWHCHD06-024	65	TWD25-065	-	
	27		TWHCHD06-027	70	TWD25-070	-	



► **Ordering Information**

SQUARE DRIVE - IMPACT SOCKETS									
Socket Size (mm)	3/4" Drive	1" Drive	1 1/2" Drive	2 1/2" Drive	Socket Size (mm)	3/4" Drive	1" Drive	1 1/2" Drive	2 1/2" Drive
	Part No.	Part No.	Part No.	Part No.		Part No.	Part No.	Part No.	Part No.
22	TWSIA022	TWSIB022	—	—	75	—	—	TWSIC075	—
24	TWSIA024	TWSIB024	—	—	80	—	TWSIB080	TWSIC080	TWSIF080
32	TWSIA032	TWSIB032	—	—	85	—	TWSIB085	TWSIC085	TWSIF085
36	TWSIA036	TWSIB036	—	—	90	—	TWSIB090	TWSIC090	TWSIF090
41	TWSIA041	TWSIB041	TWSIC041	—	95	—	TWSIB095	TWSIC095	TWSIF095
46	TWSIA046	TWSIB046	—	—	100	—	TWSIB100	—	TWSIF100
50	TWSIA050	TWSIB050	—	—	110	—	TWSIB110	TWSIC110	TWSIF110
55	—	TWSIB055	—	—	115	—	—	TWSIC115	TWSIF115
60	—	TWSIB060	TWSIC060	—	120	—	—	TWSIC120	—
65	—	TWSIB065	TWSIC065	—	135	—	—	—	TWSIF135
70	—	TWSIB070	TWSIC070	—	150	—	—	—	TWSIF150

NOTE: For Long Reach (Extended Length) sockets add "LR" to the end of the part number. For 12 point (bi-hex) sockets, add "BH" to the end of the part number.

TWSD EXTENDED REACTION ARM TWSD-ERA



Features

- Long reach version of TWSD standard reaction arm
- 3 standard sizes per model (25 mm / 50 mm / 75 mm), specials upon request
- Replaces standard reaction arm via quick release locking pin
- Steel alloy construction
- 360° rotation
- Available for full range of tool sizes

Tool Ref	Order No.	L1	L2	L3	L4	Weight (kg)
		(mm)	(mm)	(mm)	(mm)	
STD ARM		179,1	165,1			
TWSD11	TWSD11-ERA1	204,0	190,0	110,0	39,9	8
	TWSD11-ERA2	229,1	214,9			8,5
	TWSD11-ERA3	254,0	240,0			9,5
STD ARM		230,9	199,9			
TWSD25	TWSD25-ERA1	256,0	225,0	145,0	50,0	18
	TWSD25-ERA2	280,9	249,9			20
	TWSD25-ERA3	306,07	275,08			21

Ordering Information

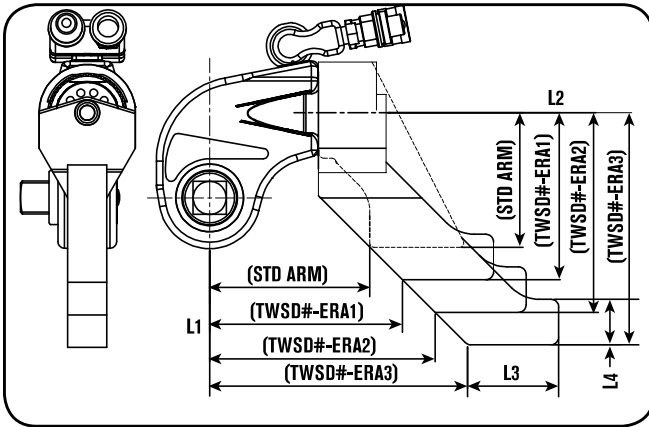

TW HANDLE



Features

- Robust steel construction with ribbed polymer grip
- Multi-position on tool for balanced handling
- Cap-screw locking with positive 'docking'
- Is suitable for all wrench models (TWHC, TWSD, TWLC). However, for larger sizes (TWSD25/ TWLC30/TWHC50) we recommend the use of eye-bolt lifting.

Ordering Information

Order No.	Description	Tool Ref
DFTAS000001	Wrench Handle	TWHC1
		TWHC3
		TWLC2

Order No.	Description	Tool Ref
DFTAS000002	Wrench Handle	TWSD11
		TWHC6
		TWLC4
		TWLC8
		TWLC15

TWSD REACTION PAD TWSD-RP



Features

- Wrench In-Line Reaction Pad for TWSD wrenches used as simple pad, or modified platform, for specific application (Machine-able/Weld-able platform)
- Replaces standard reaction arm via quick release locking pin
- Steel alloy construction
- 360° rotation
- Available for full range of tool sizes

Ordering Information

Tool Ref	Order No.	L1	L2	L3	Width (mm)	Weight (kg)
		(mm)	(mm)	(mm)		
TWSD11	TWSD11-RP	109,5	184,5	65,5	105,0	4
TWSD25	TWSD25-RP	136,5	243,5	88,5	143,0	10

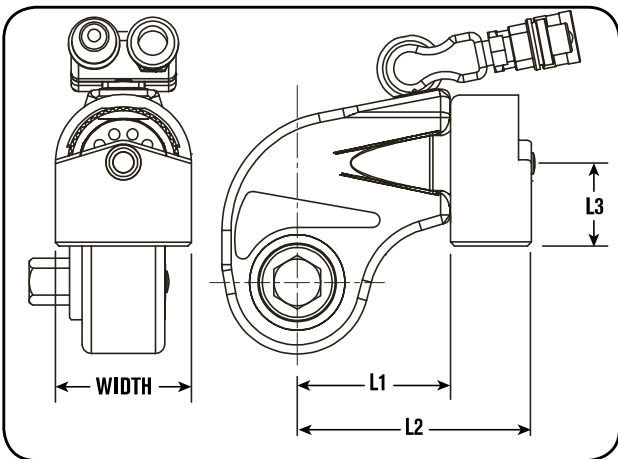

TWSD LONG REACTION ARM TWSD-LRA



Features

- Tubular extension arm for TWSD wrenches for in-line reaction outside wrench profile
- Replaces standard reaction arm via quick release locking pin
- Steel/light alloy construction (reaction flat machined on tube end)
- Can be cut down to suit specific length
- Available for full range of tool sizes

Ordering Information

Tool Ref	Order No.	L1	L2	Weight (kg)
		(mm)	(mm)	
TWSD11	TWSD11-LRA	500,9	152,4	11
TWSD25	TWSD25-LRA			22

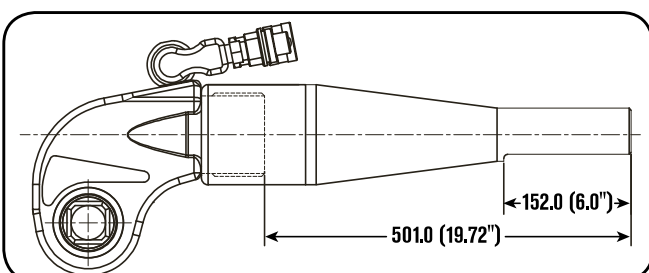

Model Shown:

TWLC Body



* Links sold separately.
Tool is not shipped with link.

Features

THE CLEARANCE TOOL FEATURES A LONG NECK, SHORT HEIGHT, AND SMALL NOSE RADIUS FOR INACCESSIBLE BOLTING AREAS FOUND IN INDUSTRY.

- Corrosion resistant finish, low weight, high strength steel body construction design with superior torsional strength.
- Fine tooth ratchet with floating piston design with small nose radius, allows for a fast operation cycle.
- Link pin does not fall out.
- Multi-axis high flow swivel manifold with internal relief valve prevents retract side over-pressurization
- “Hardened” steel reaction pad on TWLC8, 15 & 30
- Simple design, auto-connect drive piston quick interchangeable heads, no tools necessary, consistent torque output
- Replaceable reaction pad on larger models
- Power Team PowerThon™ Limited Lifetime Warranty

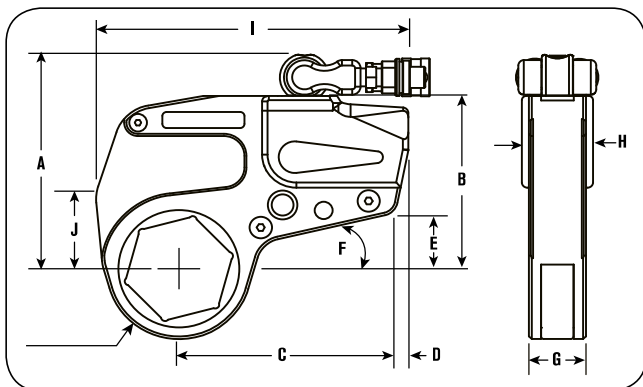

Torque Wrench Hoses - Non-Conductive Dual Line



Order No.	Hose Length (m)	Hose I.D. (in.)
TWH15	4,6	1/4"
TWH20	6,1	1/4"
TWH30	15,2	1/4"

Technical Dimensions

Body Order No.	A (mm)	B (mm)	C (mm)	D (mm)	E (mm)	F (mm)	G (mm)	H (mm)
TWLC2	96,5	104,1	127,0	7,6	35,6	12,7	33,0	43,2
TWLC4	119,4	129,5	160,0	10,2	43,2	12,7	43,2	50,8
TWLC8	147,3	157,5	177,8	25,4	40,6	15,2	53,3	66,0
TWLC15	175,3	185,4	200,7	27,9	43,2	15,2	63,5	76,2
TWLC30	223,5	238,8	266,7	25,4	61,0	15,2	81,3	94,0

Ordering Information

Tool Model	Hex Range (mm)	Min.Torque (Nm)	Max.Torque (Nm)	Weight. (Body Only) (kg)
TWLC2	26 - 50	256	2135	1,0
TWLC4	33 - 80	647	5389	2,0
TWLC8	49 - 100	1293	10779	3,5
TWLC15	62 - 116	2416	20134	7,0
TWLC30	80 - 115	4686	39048	14,5



Special sizes available upon request.

LOW CLEARANCE - REDUCERS								
Body Order No.	Link	Nut A/F (mm)	Reducer (mm)	Reducer	Reducer (mm)	Reducer	Reducer (mm)	Reducer
	Part No.			Part No.		Part No.		Part No.
TWLC2	TWL2-032	32	—	—	—	—	—	—
	TWL2-036	36	—	—	—	—	—	—
	TWL2-041	41	41-36	TWR2-041036	41-32	TWR2-041032	—	—
	TWL2-046	46	46-41	TWR2-046041	46-36	TWR2-046036	46-32	TWR2-046032
	TWL2-050	50	50-46	TWR2-050046	50-41	TWR2-050041	50-36	TWR2-050036
	TWL2-055	55	55-50	TWR2-055050	55-46	TWR2-055046	55-41	TWR2-055041
TWLC4	TWL4-041	41	41-36	TWR4-041036	41-32	TWR4-041032	—	—
	TWL4-046	46	46-41	TWR4-046041	46-36	TWR4-046036	46-32	TWR4-046032
	TWL4-050	50	50-46	TWR4-050046	50-41	TWR4-050041	50-36	TWR4-050036
	TWL4-055	55	55-50	TWR4-055050	55-46	TWR4-055046	55-41	TWR4-055041
	TWL4-060	60	60-55	TWR4-060055	60-50	TWR4-060050	60-46	TWR4-060046
	TWL4-065	65	65-60	TWR4-065060	65-55	TWR4-065055	65-50	TWR4-065050
	TWL4-070	70	70-65	TWR4-070065	70-60	TWR4-070060	70-55	TWR4-070055
	TWL4-075	75	75-70	TWR4-075070	75-65	TWR4-075065	75-60	TWR4-075060
TWLC8	TWL8-060	60	60-55	TWR8-060055	60-50	TWR8-060050	60-46	TWR8-060046
	TWL8-065	65	65-60	TWR8-065060	65-55	TWR8-065055	65-50	TWR8-065050
	TWL8-070	70	70-65	TWR8-070065	70-60	TWR8-070060	70-55	TWR8-070055
	TWL8-075	75	75-70	TWR8-075070	75-65	TWR8-075065	75-60	TWR8-075060
	TWL8-080	80	80-75	TWR8-080075	80-70	TWR8-080070	80-65	TWR8-080065
	TWL8-085	85	85-70	TWR8-085080	85-65	TWR8-085075	85-70	TWR8-085070
	TWL8-090	90	90-85	TWR8-090085	90-80	TWR8-090080	90-75	TWR8-090075
	TWL8-095	95	95-90	TWR8-095090	95-85	TWR8-095085	95-80	TWR8-095080
TWLC15	TWL15-070	70	70-65	TWR15-070065	70-60	TWR15-070060	70-55	TWR15-070055
	TWL15-075	75	75-70	TWR15-075070	75-65	TWR15-075065	75-60	TWR15-075060
	TWL15-080	80	80-75	TWR15-080075	80-70	TWR15-080070	80-65	TWR15-080065
	TWL15-085	85	85-80	TWR15-085080	85-75	TWR15-085075	85-70	TWR15-085070
	TWL15-090	90	90-85	TWR15-090085	90-80	TWR15-090080	90-75	TWR15-090075
	TWL15-095	95	95-90	TWR15-095090	95-85	TWR15-095085	95-80	TWR15-095080
	TWL15-100	100	100-95	TWR15-100095	100-90	TWR15-100090	100-85	TWR15-100085
	TWL15-105	105	105-100	—	105-95	—	105-90	—
	TWL15-425	—	—	TWR15-425388	—	TWR15-425375	—	TWR15-425350
	TWL15-110	110	110-105	—	110-100	—	110-95	—
TWLC30	TWL15-115	115	115-110	—	115-105	—	115-100	—
	TWL15-463	—	—	TWR15-463425	—	TWR15-463388	—	TWR15-463375
	TWL30-080	80	80-75	TWR30-080075	80-70	TWR30-080070	80-65	TWR30-080065
	TWL30-085	85	85-80	TWR30-085080	85-65	TWR30-085075	85-70	TWR30-085070
	TWL30-090	90	90-85	TWR30-090085	90-80	TWR30-090080	90-75	TWR30-090075
	TWL30-095	95	95-90	TWR30-095090	95-85	TWR30-095085	95-80	TWR30-095080
	TWL30-100	100	100-95	TWR30-100095	100-90	TWR30-100090	100-85	TWR30-100085
	TWL30-105	105	105-100	TWR30-105100	105-95	TWR30-105095	105-90	TWR30-105090
	TWL30-425	—	—	TWR30-425388	—	TWR30-425375	—	TWR30-425350
	TWL30-110	110	110-105	—	110-100	—	110-95	—
	TWL30-115	115	115-110	—	115-105	—	115-100	—
	TWL30-463	—	—	TWR30-463425	—	TWR30-463388	—	TWR30-463375
	TWL30-120	120	120-115	—	120-110	—	120-105	—
	TWL30-500	—	—	TWR30-500463	—	TWR30-500425	—	TWR30-500388
	TWL30-130	130	130-120	—	130-115	—	130-110	—
TWL30-135	135	135-125	TWR30-135125	135-120	TWR30-135120	135-115	TWR30-135115	
TWL30-145	145	—	—	—	—	—	—	
TWL30-150	150	—	—	—	—	—	—	
TWL30-155	155	—	—	—	—	—	—	

AVAILABLE UPON REQUEST

Nut A/F	TWLC2					TWLC4					TWLC8				
	Link Order No.	Radius R	I	J	Weight (Link Only)	Link Order No.	Radius R	I	J	Weight (Link Only)	Link Order No.	Radius R	I	J	Weight (Link Only)
	(mm)	(mm)	(mm)	(mm)	(kg)	(mm)	(mm)	(mm)	(mm)	(kg)	(mm)	(mm)	(mm)	(mm)	(kg)
26	TWL2-026	31,5	180,1	38,1	2	-	36,6	227,1	53,1	224,0	-	50,5	274,1	77,0	7
27	TWL2-027					-									
29	TWL2-029					-									
30	TWL2-030					-									
32	TWL2-032					-									
33	TWL2-033					TWL4-033									
35	TWL2-035	TWL4-035													
36	TWL2-036	TWL4-036													
38	TWL2-150	34,5	181,1	39,9	2	TWL4-150	39,1	227,1	53,1	4	TWL8-188	67,1	277,11	71,9	8
40	TWL2-040					TWL4-040									
41	TWL2-041					TWL4-041									
43	TWL2-043	37,1	182,9	39,9	2	TWL4-043	50,0	227,1	53,1	4	TWL8-052	73,41	277,11	71,88	8
44	TWL2-044					TWL4-044									
46	TWL2-046	TWL4-046													
48	TWL2-188	39,9	184,9	42,9	2	TWL4-188	41,9	227,1	53,1	4	TWL8-049	58,4	274,1	77,0	7,5
49	TWL2-049					TWL4-049									
50	TWL2-050					TWL4-050									
52	TWL2-052	42,4	184,9	42,9	2	TWL4-052	44,5	227,1	53,1	4	TWL8-054	55,9	274,1	77,0	7,5
54	TWL2-054					TWL4-054									
55	TWL2-055					TWL4-055									
57	TWL2-057	45,5	184,91	42,9	2	TWL4-225	47,5	227,1	53,1	4	TWL8-057	62,0	277,1	71,9	8
59	TWL2-059					TWL4-059									
60	TWL2-060					TWL4-060									
62	-	-	-	-	-	TWL4-062	50,0	227,1	53,1	4	TWL8-062	53,1	274,1	77,0	7,5
63	-					TWL4-063									
65	-					TWL4-065									
67	-					TWL4-067									
68	-					TWL4-068									
70	-					TWL4-070									
71	-					TWL4-071									
73	-					TWL4-073									
75	-					TWL4-075									
77	-					TWL4-077									
78	-	TWL4-313	58,93	230,12	57,91	4,5	TWL8-313	62,0	277,1	71,9	8				
80	-	TWL4-080													
81	-	-	-	-	-	-	-	-	-	-	TWL8-081	67,1	277,11	71,9	8
83	-										TWL8-083				
84	-										TWL8-084				
85	-										TWL8-085				
87	-										TWL8-087				
89	-										TWL8-089				
90	-										TWL8-090				
91	-										TWL8-091				
92	-										TWL8-092				
94	-										TWL8-094				
95	-	TWL8-095	73,41	277,11	71,88	8	TWL8-097								
97	-	TWL8-388													
99	-	TWL8-100													
100	-	TWL8-100													

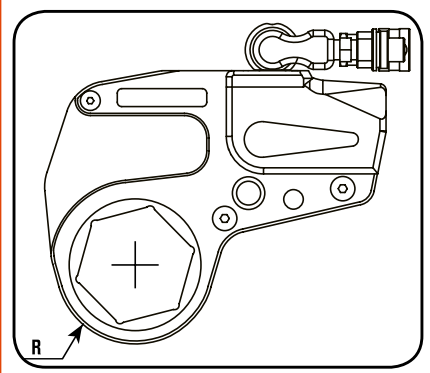

NOTE: The sizes listed on these pages encompass both heavy hex and standard hex nut sizes. Check your local SPX FLOW Power Team Office for availability as some items may be special order.

Nut A/F (mm)	TWLC15					TWLC30					Nut A/F (mm)	TWLC30 (Continued)				
	Link Order No.	Radius R (mm)	I (mm)	J (mm)	Weight (Link Only) (kg)	Link Order No.	Radius R (mm)	I (mm)	J (mm)	Weight (Link Only) (kg)		Link Order No.	Radius R (mm)	I (mm)	J (mm)	Weight (Link Only) (kg)
62	TWL15-062					-					122	TWL30-122				
63	TWL15-063					-					123	TWL30-123				
65	TWL15-065	60,5	312,9	87,9	12,5	-					124	TWL30-124	99,1	400,1	109,0	28,5
67	TWL15-067					-					125	TWL30-125				
68	TWL15-068					-					127	TWL30-500				
70	TWL15-070					-					129	TWL30-129				
71	TWL15-071					-					130	TWL30-130				
73	TWL15-073	63,0	312,9	87,9	12,5	-					132	TWL30-132	104,9	400,1	109,0	28,5
75	TWL15-075					-					133	TWL30-133				
77	TWL15-077					-					135	TWL30-135				
78	TWL15-313	66,5	312,9	87,9	13	-					137	TWL30-538				
80	TWL15-080					TWL30-080					138	TWL30-138				
81	TWL15-081					TWL30-081					140	TWL30-140				
83	TWL15-083					TWL30-083					141	TWL30-141				
84	TWL15-084					TWL30-084	77,0	392,9	103,9	26,5	143	TWL30-143	110,0	400,1	109,0	28,5
85	TWL15-085	71,9	312,9	87,9	13,5	TWL30-085					144	TWL30-144				
87	TWL15-087					TWL30-087					145	TWL30-145				
89	TWL15-089					TWL30-089					146	TWL30-146				
90	TWL15-090					TWL30-090					148	TWL30-148				
91	TWL15-091					TWL30-091					149	TWL30-149				
92	TWL15-092					TWL30-092					150	TWL30-150				
94	TWL15-094					TWL30-094					151	TWL30-151	116,1	400,1	109,0	29,5
95	TWL15-095	78,0	316,0	80,0	13,5	TWL30-095	83,1	392,9	103,9	26,5	152	TWL30-152				
97	TWL15-097					TWL30-097					154	TWL30-154				
99	TWL15-388					TWL30-388					155	TWL30-155				
100	TWL15-100					TWL30-100										
102	TWL15-102					TWL30-102										
103	TWL15-103					TWL30-103										
105	TWL15-105	82,6	316,0	80,0	14	TWL30-105	88,9	392,9	103,9	27,5						
106	TWL15-106					TWL30-106										
108	TWL15-425					TWL30-425										
110	TWL15-110					TWL30-110										
111	TWL15-111					TWL30-111										
113	TWL15-113					TWL30-113										
114	TWL15-114	87,4	316,0	80,0	14	TWL30-114	91,9	392,9	103,9	27,5						
115	TWL15-115					TWL30-115										
116	TWL15-116					TWL30-116										
117	TWL15-463					TWL30-463										
119	-					TWL30-119	99,1	400,1	109,0	28,5						
120	-					TWL30-120										

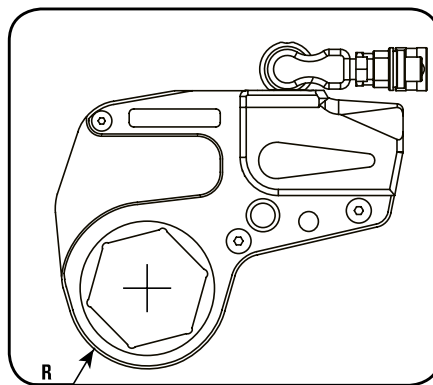

To Specify a TWLC solution:

1. Find a link for your application (nut size)
2. Choose the appropriate drive body
3. Add reducers for additional nut sizes

NOTE: Please order Drive Body and Link separately and pay attention to the same size, for Example TWLC2 and TWL2-041.

TWLC REACTION BAR TWLC-RB

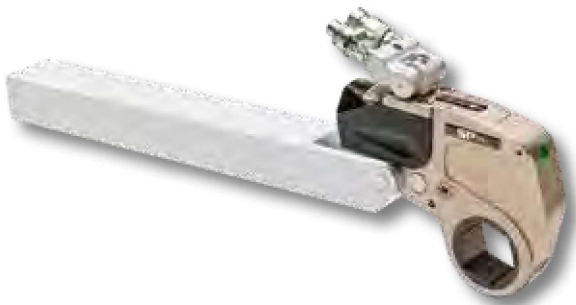

Features

- In-Line Extension Reaction Bar for TWLC wrenches allows extended reach on the same plane
- Pin engagement, no tools required
- Available for full range of tool sizes



Reaction Accessories

Power Team offers a varied range of alternative and optional reaction accessories which help to find a reaction point solution no matter how unusual the bolted application is.

Ordering Information

Tool Ref	Order No.	L1 (mm)	L2 (mm)	L3 (mm)	Weight (kg)
TWLC2	TWLC2-RB	381,0	27,9	55,1	2,6
TWLC4	TWLC4-RB	457,2	35,1	66,0	4,8
TWLC8	TWLC8-RB	457,2	37,1	85,1	9,0
TWLC15	TWLC15-RB	508,0	40,0	102,0	14,5
TWLC30	TWLC30-RB	508,0	35,0	127,0	27,0

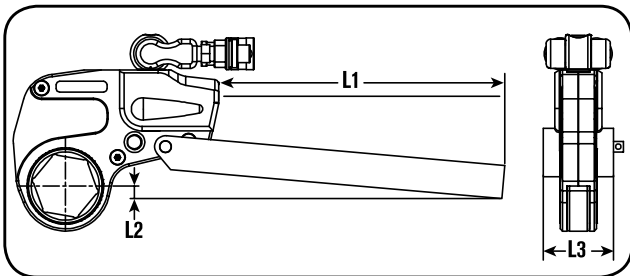

TWLC REACTION PADDLE TWLC-RP



Features

- Off-Set Reaction Arm for TWLC wrenches allows off-set reaction within wrench profile
- Pin engagement, no tools required
- Light alloy construction
- Available for full range of tool

Ordering Information

Tool Ref	Order No.	L1 (mm)	L2 (mm)	L3 (mm)	L4 (mm)	Weight (kg)
TWLC2	TWLC2-RP	84,1	35,1	142,0	13,0	0,5
TWLC4	TWLC4-RP	109,0	46,0	178,1	19,1	0,9
TWLC8	TWLC8-RP	136,4	57,2	220,0	25,9	1,8
TWLC15	TWLC15-RP	165,1	70,1	252,0	45,0	3,5
TWLC30	TWLC30-RP	200,0	86,1	317,0	43,9	6,0

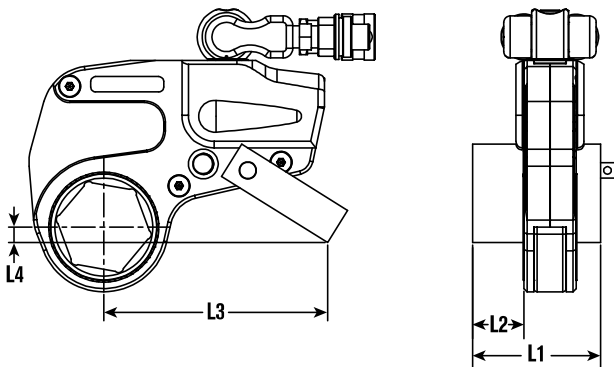

**HAVE A UNIQUE APPLICATION?
DOES STANDARD PRODUCT NOT FIT?**



CUSTOM REACTION PADS AND REDUCERS ARE AVAILABLE.

Contact SPX FLOW or an authorized Power Team distributor for more details!

**WHEN NOTHING ELSE WILL WORK,
SPLIT ADAPTERS ARE MADE TO ORDER
AND AVAILABLE UPON REQUEST.**



TWLC15 split adapter,
closed position



TWLC15 split adapter,
open position

Model Shown:

TWSL4-046 Link (left) & TWSL4-060 Link with TWLC4 Drive Body (right)



Features

ENGINEERED TO FIT INACCESSIBLE APPLICATIONS WITH MINIMAL CLEARANCE.

- Dynamic engineering modeling (Finite Element Analysis and optimized tool design to extend life and durability).
- The SlimLine links use the same quick change Drive Body as the existing TWLC links
- Small nose radius, fits all standard API and ANSI flanges.
- Rigid steel body construction with corrosion resistant plating.
- Fully-enclosed drive mechanism for operator safety.
- Swivel manifold has an internal relief valve to prevent retract side over-pressurization.
- Multi-axis swivel technology for free positioning of tool and hoses.



Drive Body interchanges with the TWLC & TWSL link sizes

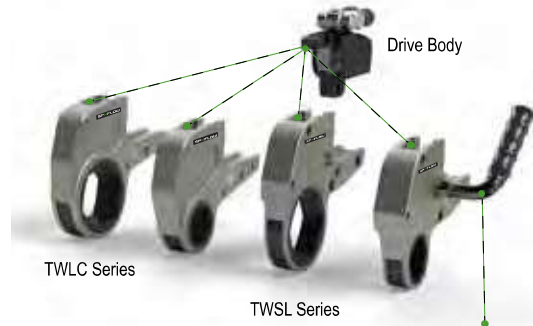

Optional Handle
Order #: DFTAS000002

The Drive Body is designed to interchange with the TWLC (Low Clearance) and the new TWSL (SlimLine) Links, lowering your tool investment across each series to broaden your application reach.

Tools

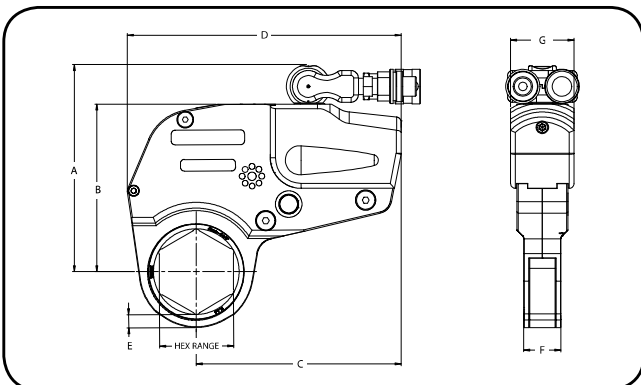

Technical Dimensions

Order No.	A (mm)	B (mm)	C (mm)	D (mm)	E (mm)	F (mm)	G (mm)
TWSL4	167,9	136,9	167,9	224,3	10,7	30,5	51,8

NOTE: Sizes; TWSL2-# and TWSL8-#, contact factory for details.

► **Technical Fit Overview**



SlimLine Application Range

Due to the compact design, the maximum torque of the TWSL links vary depending on link size, reference the information below for complete details.

New SlimLine* (TWSL Series) Standard (TWLC Series)

*Shown with optional handle, order # DFTAS000002.

► The TWSL's narrow width and reduced radius design enables the tool to fit into tight areas where standard low clearance links cannot.

► **Torque Wrench Drive Body Ordering Information for SlimLine**

Drive Body Order No.	Hex Range for SlimLine		SlimLine Min. Torque (Nm)	SlimLine Max. Torque (Nm)	Weight (Link Only) (kg)
	(mm)	(mm)			
TWLC2	28,7	60,5	Contact Factory for Details		1,0
TWLC4	46,0	79,5	685	3577 - 5707	2,0
TWLC8	57,2	100,1	Contact Factory for Details		3,5

Note: Links are sold separately from the drive body, refer to the tables below.

► **Torque Wrench Link Ordering Information for SlimLine**

Link Order No.	Hex Range for SlimLine		SlimLine Min. Torque (Nm)	SlimLine Max. Torque (Nm)	Weight (Link Only) (kg)
	(mm)	(mm)			
TWSL2-#	28,7	60,5	Contact Factory for Details		
TWSL4-#	46,0	79,5	685	3577 - 5707	3,6 - 3,8
TWSL8-#	57,2	100,1	Contact Factory for Details		

Note: The "#" suffix will be replaced with the actual link size in a numeric value.

► **TWSL4 SlimLine Link Reference Table***

Nut A/F (mm)	Link Order No.	Max. Torque (Nm)	Weight (Link Only) (kg)
46,0	TWSL4-046	3577	3,6
50,8	TWSL4-050	4434	3,7
55,6	TWSL4-055	4837	3,7
60,5	TWSL4-060	5242	3,8
65,0	TWSL4-065	5708	3,8
69,9	TWSL4-070	5708	3,8
74,7	TWSL4-075	5708	3,8
79,5	TWSL4-080	5708	3,8

Other Related Items

Contact your nearest Power Team sales representative for assistance in sizing the proper tool for your application, or go to powerteam.com website for details about other available link sizes not listed.

Pumps Hoses Tools